

Mini Roundabout Concept

44th Ave., Fremont Ave., Webber Pkwy. | Hennepin County Public Works

HENNEPIN COUNTY
MINNESOTA

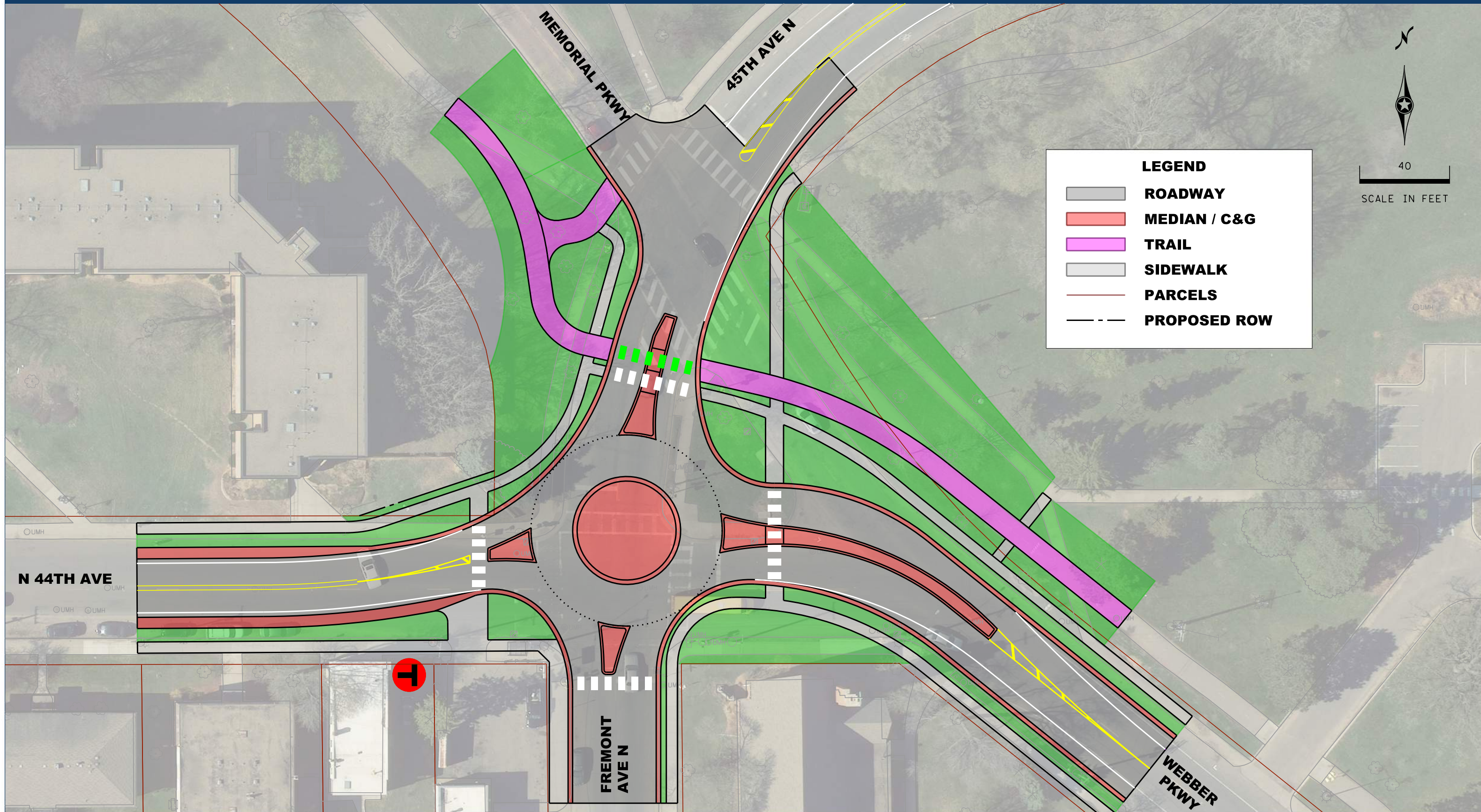

LEGEND

- ROADWAY
- MEDIAN / C&G
- TRAIL
- SIDEWALK
- PARCELS
- PROPOSED ROW

40
SCALE IN FEET

Disclaimer: This map (i) is furnished "AS IS" with no representation as to completeness or accuracy; (ii) is furnished with no warranty of any kind; and (iii) is not suitable for legal, engineering or surveying purposes. Hennepin County shall not be liable for any damage, injury or loss resulting from this map.

Publication date: \$DATE\$ \$username\$ \$FILEL\$

